



hergom

# WOOD STOVES & FIREPLACES

PRODUCT CATALOGUE 2017-2018



# ON FIRE SINCE 1959

*"If you want perfection, do it yourself"*



## HERGÓM

Founded in 1959, Hergóm is today one of the main manufacturers of hearth products worldwide. Through more than half a century, Hergóm has gained success and experience in developing wood and biomass heating appliances, focusing on natural fuels, through research, development and improvement of the efficiency of our products.

## FOUNDRY

Owning a foundry, we use fine-cast iron as a primary source for our products. Cast iron grants our hearth appliances high durability, attractive and unique looks, and releases a steady, cozy and gentle warmth thanks to its thermal inertia, remaining warm for several hours after the fire has gone out.



## PERFECTION

At Hergóm we know that to get to perfection, it is better to do everything ourselves. Every step, from design and engineering to the finished product, is carried out at our own facilities: castings, machining, ceramic enameling, final assembly... to make sure that your appliance is built in the rich tradition of our company, and will serve you faithfully for years to come.



## ON FIRE

Everyday more and more consumers are discovering the benefits of wood heating, which is today one of the most economic and pleasant ways of heating their homes. With over 50 years of experience in designing and manufacturing hearth products, your Hergóm purchase represents not only the latest in aesthetic advances, but also the utmost in powerful heating technology. It's this integrity that gives Hergóm products their unmatched appeal, and has for over 50 years. All Hergóm stoves and fireplaces meet UNE-EN-13229 standards that ensure thermal values and performance.





# INDEX

GENERAL CATALOGUE 2017 / 2018

STOVES 6

FIREPLACE INSERTS 24

WOOD BURNING OVENS 46

TECHNICAL INFORMATION 52



# STOVES

Fabricated entirely of top-quality grey cast iron shaped in a modern state-of-the-art moulding plant, our line of stoves sets the bar for quality. Exclusive design features ensure each appliance is economical and safe, providing clean and complete combustion for warmth you can trust. Whether it is classic painted iron or vitreous enamel glazed, our stoves are as beautiful as they are functional - with optimized fire viewing areas and distinctive character down to the last detail.





# GLANCE SERIES

DESIGNED  
BY STRAND + HVAAS

Creations by Danish studio Strand + Hvaas, located in Copenhagen, are based on Scandinavian design tradition: simplicity and clean lines.

Works by Niels Hvaas and Christina Strand include various commercial successes and experimental projects, and is based on improving the user's interacting with their products. That is why the Glance Series is focused on providing the best user experience. Clean and balanced lines are the core of its design and the key of its allure to international consumers.



## ENJOY FIRE

The firebox of the Glance Series stoves is composed by three ceramic glass walls under a cast iron structure, allowing you to enjoy the glow of the flames from all angles. The firebox is airtight, keeping uncontrolled air from entering the combustion process and granting you full control of the burn rate. Glass will remain always clean thanks to Hergóm's Airwash system, which drives air currents to the inner surface of the glass, keeping it free from soot and offering a perfect view of the fire.



# GLANCE L

Nominal heat output: 9,5 kw  
Efficiency: 77%  
Dimensions (An. x AL. x P.): 700 x 825 x 411







# GLANCE

Nominal heat output: 7 kw  
Efficiency: 80%  
Dimensions (An. x AL. x P.): 550 x 825 x 415

# GLANCE WM

Nominal heat output: 7 kw  
Efficiency: 80%  
Dimensions (An. x AL. x P.): 550 x 825 x 415





# E-40

Nominal heat output: 9 kw

Efficiency: 79,2%

Dimensions (An. x Al. x P.): 600 x 870 x 430





# E-30 L

Nominal heat output: 11 kw  
Efficiency: 79,3%  
Dimensions (An. x AL x P.): 600 x 870 x 430



# E-30 M

Nominal heat output: 9 kw  
Efficiency: 79,2%  
Dimensions (An. x AL x P.): 660 x 740 x 540







# E-30 S

Nominal heat output: 7 kw  
Efficiency: 79,1%  
Dimensions (An. x AL. x P.): 590 x 699 x 492



Nominal heat output: 5 kw  
Efficiency: 76,7%  
Dimensions (An. x AL. x P.): 455 x 522 x 456

# E-30 XS



The new E-30 XS multifuel stove is designed to burn coal as well as wood, offering an efficient, optimum combustion with both fuels.



# E-20 NS

Nominal heat output: 8 kw  
Efficiency: 75%  
Dimensions (An. x AL. x P.): 580 x 715 x 415



# FIREPLACE INSERTS

Every day, more homeowners are in search of a solution to modernize their old, inefficient open fireplace. Hergóm has created a new range of fireplace inserts designed to be installed in new buildings, or to replace existing open fireplaces.

Our solutions enable you to continue enjoying fire as before, but with greater safety, comfort and efficiency. If you already had a fireplace, now you may have a Hergóm fireplace.





# HEATING SOLUTIONS

Hergóm offers you different options to heat your home by burning wood.

## AIR DISTRIBUTION

Most Hergóm fireplaces feature a steel jacket with connections to drive hot air to nearby rooms, through a blower system or natural convection.

**Heat your whole house with your wood burning fireplace**

## EVEN WARMTH

Hergóm compact inserts are perfect to heat a large room. With their quiet, 3 speed blowers they drive hot air into the room, warming up the space quickly and evenly.



## WATER HEATING FIREPLACES

Hergóm's central heating fireplaces allow you to heat your entire home while you enjoy the warmth of the fire in your living room. The wood fireplace features a water tank that connects to the house's radiators and hot water network. By using it as a single heat source, or combining it with a conventional boiler, you can save up to 40% in your heating bills.







# C12

Nominal heat output: 8,8 kw  
Efficiency: 74,8%  
Dimensions (An. x AL. x P.): 700 x 585 x 458

# SERE 100 2C

Nominal heat output: 12 kw  
Efficiency: 78,2%  
Dimensions (An. x AL. x P.): 1.015 x 610 x 575

The Sere 100 2C fireplace insert features 2 glass doors that allow you to enjoy the fireview from two different rooms, or from two different areas in the same room. Wood can be loaded from both sides.





# SERE 100

Nominal heat output: 12 kw  
Efficiency: 75%  
Dimensions (An. x AL x P.): 1.015 x 609 x 483



# SERE 80

Nominal heat output: 10 kw  
Efficiency: 73,2%  
Dimensions (An. x AL x P.): 815 x 609 x 483



# SERE 70

Nominal heat output: 8,9 kw  
Efficiency: 71,3%  
Dimensions (An. x AL x P.): 715 x 540 x 483





# NATURE SERIES

Built in cast iron and featuring a large ceramic glass for a panoramic fire view, the Nature fireplace inserts family is state-of-the-art burning technology, a sophisticated and efficient heat source. The double combustion system and the airtight firebox, lined in refractory or cast iron, guarantees a high temperature in the combustion chamber. As a result, a complete and long lasting burn process is achieved.

## THE NATURE ADVANTAGES

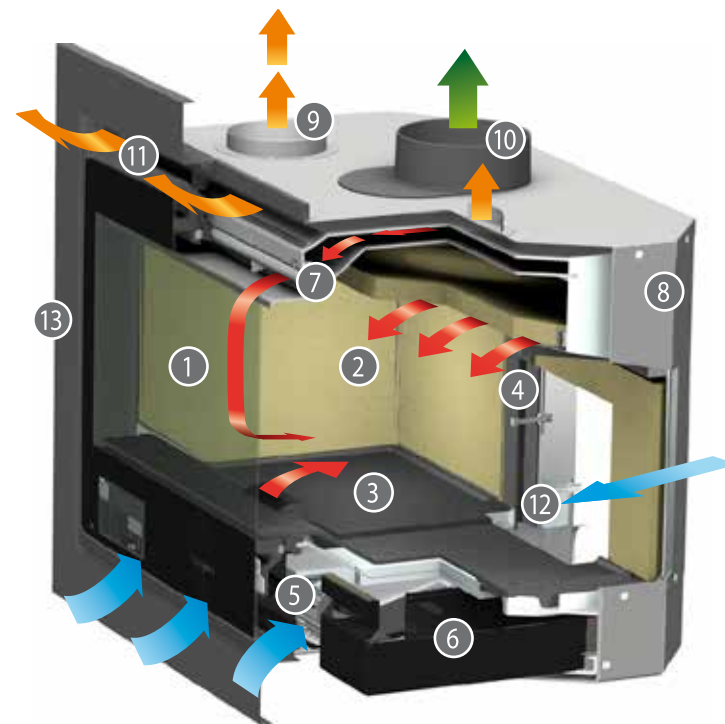

- Primary air intake
- Convection air
- Combustion air
- Smoke exit

- ① Ceramic glass with patented invisible attachment to the cast iron door frame (PAT. ES2381288B1).
- ② Firebox lining in cast iron or refractory material.
- ③ Firebox bottom in cast iron.
- ④ Double combustion system.
- ⑤ Convection turbine with adjustable speed.
- ⑥ High capacity removable ash pan.
- ⑦ Airwash clean glass system
- ⑧ Convection steel jacket.
- ⑨ Convection air outlets.
- ⑩ Two position adjustable flue collar.
- ⑪ Front convection air exit.
- ⑫ External combustion air inlet.
- ⑬ Finishing frame.

## REMOTE CONTROL



Nature inserts allow you to adjust combustion air flow easy and conveniently through the remote control. Featuring an auto mode, the appliance adjusts automatically the air intake according to its temperature, optimizing its efficiency and protecting it from overheating.

# NATURE 100

Nominal heat output: 12 kw  
Efficiency: 77,1%  
Dimensions (An. x AL. x P.): 998 x 598 x 543







# NATURE 80

Nominal heat output: 10 kw  
Efficiency: 76%  
Dimensions (An. x AL. x P.): 798 x 548 x 492

# NATURE 70

Nominal heat output: 8,5 kw  
Efficiency: 75,4%  
Dimensions (An. x AL. x P.): 698 x 548 x 492







## SLIDING DOOR FIREPLACES

Hergóm's sliding door fireplaces are the perfect appliances to give a touch of warmth and distinction to your most appreciated living spaces. Their modern designs, balanced proportions and oversized glass surfaces allow for a unique fire-viewing experience. Glass frames slide smoothly upwards for an unobstructed view of the fire. Additionally, door panels are hinged to allow you for an easy cleaning of the window panels. Most models feature a convection jacket and fans to drive hot air to other rooms.

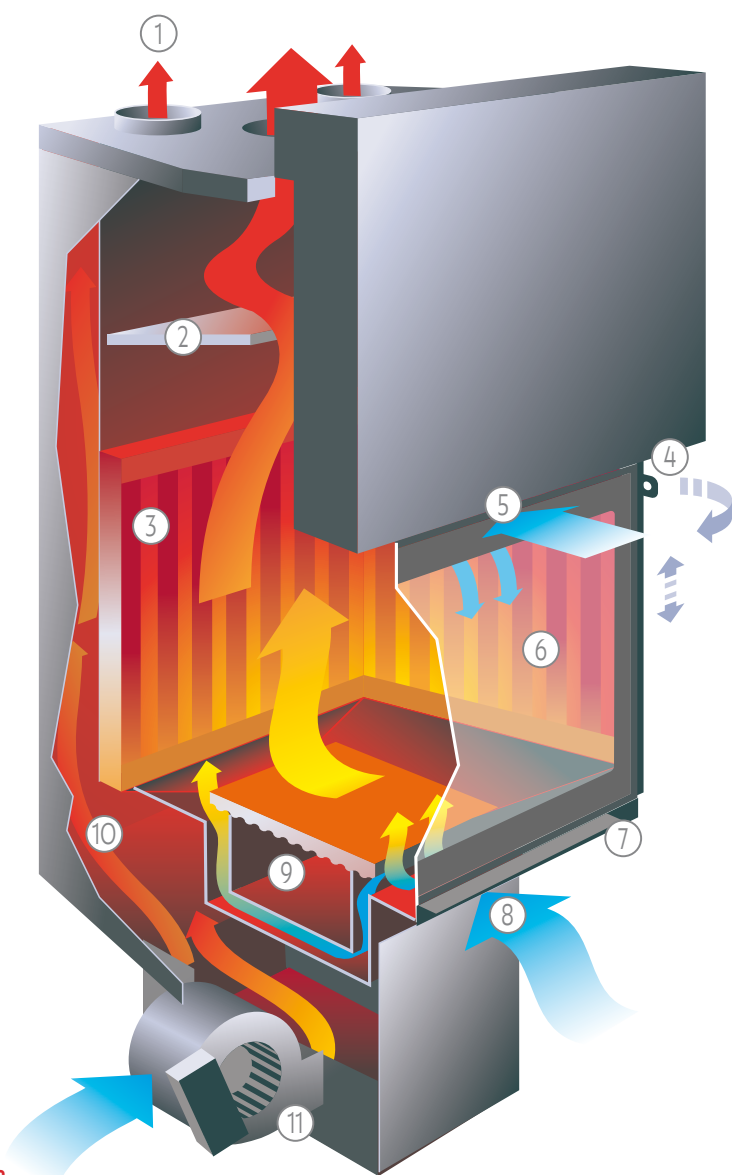

- ① Convection outlet for hot air channeling to nearby rooms.
- ② Ceramic walls and baffle, that keep high temperatures inside the firebox and increase efficiency.
- ③ Adjustable secondary air intake and "Airwash" glass cleaning system.
- ④ Oscillating door opening.
- ⑤ Ceramic glass.
- ⑥ Sliding door opening.
- ⑦ Adjustable combustion air inlet.
- ⑧ Removable ash pan.
- ⑨ Steel convection jacket.
- ⑩ Convection air intake and convection blower (optional).

## STILKAMIN XL

Nominal heat output: 23 kw  
Efficiency: 75,1 %  
Dimensions (An. x AL x P.): 1.315 x 1.415 x 601  
Dimensions glass (An x AL): 1.120 x 520



## STILKAMIN L

Nominal heat output: 20 kw  
Efficiency: 76 %  
Dimensions (An. x AL x P.): 1.121 x 1.471 x 591  
Dimensions glass (An x AL): 920 x 520

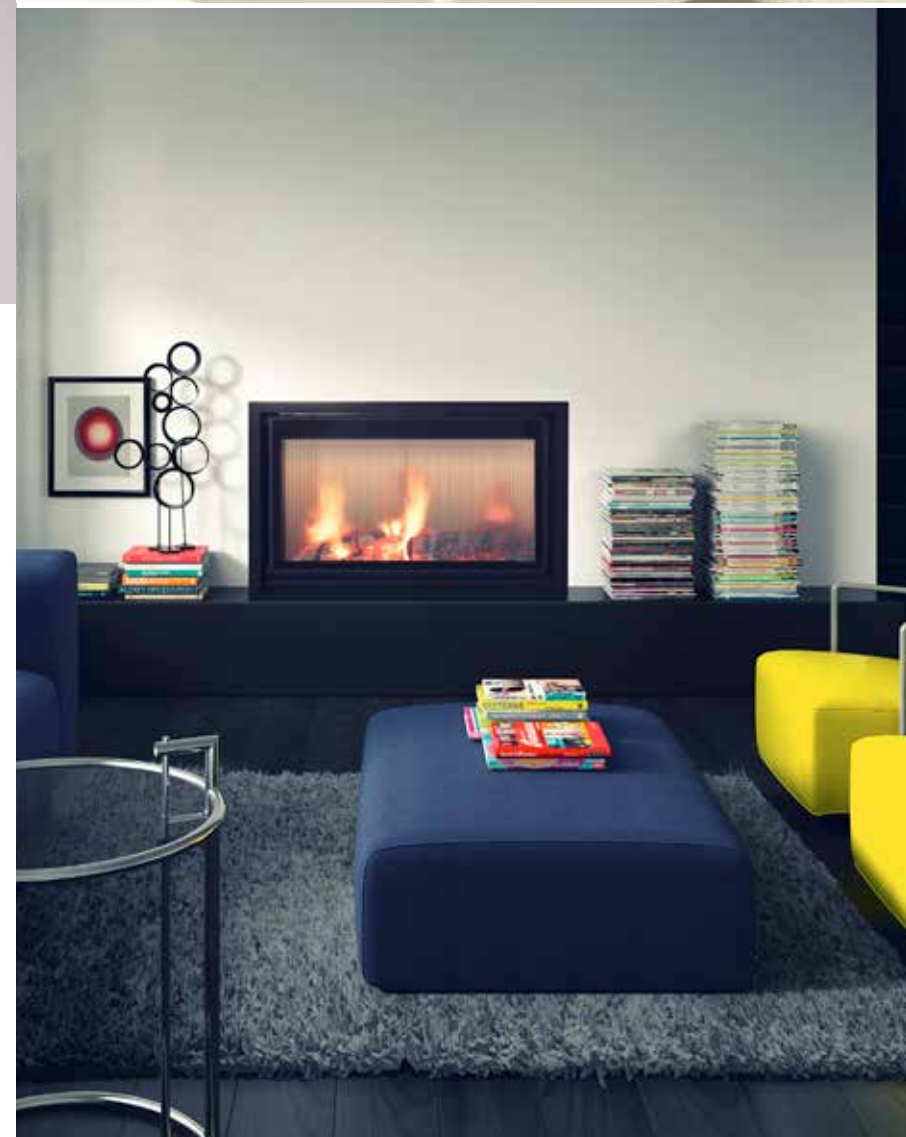



Nominal heat output: 17 kw  
Efficiency: 77 %  
Dimensions (An. x AL. x P.): 909 x 1.553 x 599  
Dimensions glass (An x AL): 720 x 600

# STILKAMIN S 600



# STILKAMIN S 460

Nominal heat output: 17,5 kw  
Efficiency: 79 %  
Dimensions (An. x AL. x P.): 919 x 1.553 x 599  
Dimensions glass (An x AL): 720 x 460





# ECK

Nominal heat output: 13 kw  
Efficiency: 75 %  
Dimensions (An. x AL x P.): 849 x 1.250 x 615  
Dimensions glass (An x AL x P.): 770 x 513 x 357



# H 03/70 PLANE

Nominal heat output: 10 kw  
Efficiency: 76,5 %  
Dimensions (An. x AL x P.): 700 x 755 x 468

# H 03/80 PLANE

Nominal heat output: 13 kw  
Efficiency: 76,1 %  
Dimensions (An. x AL x P.): 800 x 814 x 468



BOTH H-03 MODELS ARE AVAILABLE IN TURBO-CONVECTOR  
VERSION WITH CONVECTION BLOWERS

# HGB 70

Nominal heat output: 13 kw  
Efficiency: 80 %  
Dimensions (An. x AL x P.): 693 x 677 x 429





Central heating fireplaces allow you to heat your entire home while you enjoy the warmth of the fire in your living room.  
The wood fireplace features a water tank that connects to the house's radiators and hot water network.

Model H-03/70 includes a factory built-in cooling coil and thermostat.

## H 03/70 BOILER

Nominal heat output: 23 kw  
Efficiency: 83 %  
Dimensions (An. x AL x P.): 700 x 985 x 500



## H 03/80 BOILER

Nominal heat output: 25 kw  
Efficiency: 70 %  
Dimensions (An. x AL x P.): 785 x 1.190 x 580







Nominal heat output: 35 kw  
Efficiency: 72,8 %  
Dimensions (An. x AL. x P.): 936 x 1.268 x 690

## DERO BOILER

## H 02/22 BOILER

Nominal heat output: 25 kw  
Efficiency: 70 %  
Dimensions (An. x AL. x P.): 790 x 1.172 x 580





# WOOD FIRED OVENS

Hergóm roasting ovens that use all available advances and technologies to provide a perfect log grill. Enhanced control over temperature, faster cooking times, and independent cooking chambers that prevent smoke and soot from affecting the flavor of your food. Our wood burning ovens are an innovative combination of cast iron and stainless steel, in strict compliance with food hygiene standards. The most traditional and delicious dishes can now be prepared in these ovens, conceived for indoor or sheltered outdoor use.



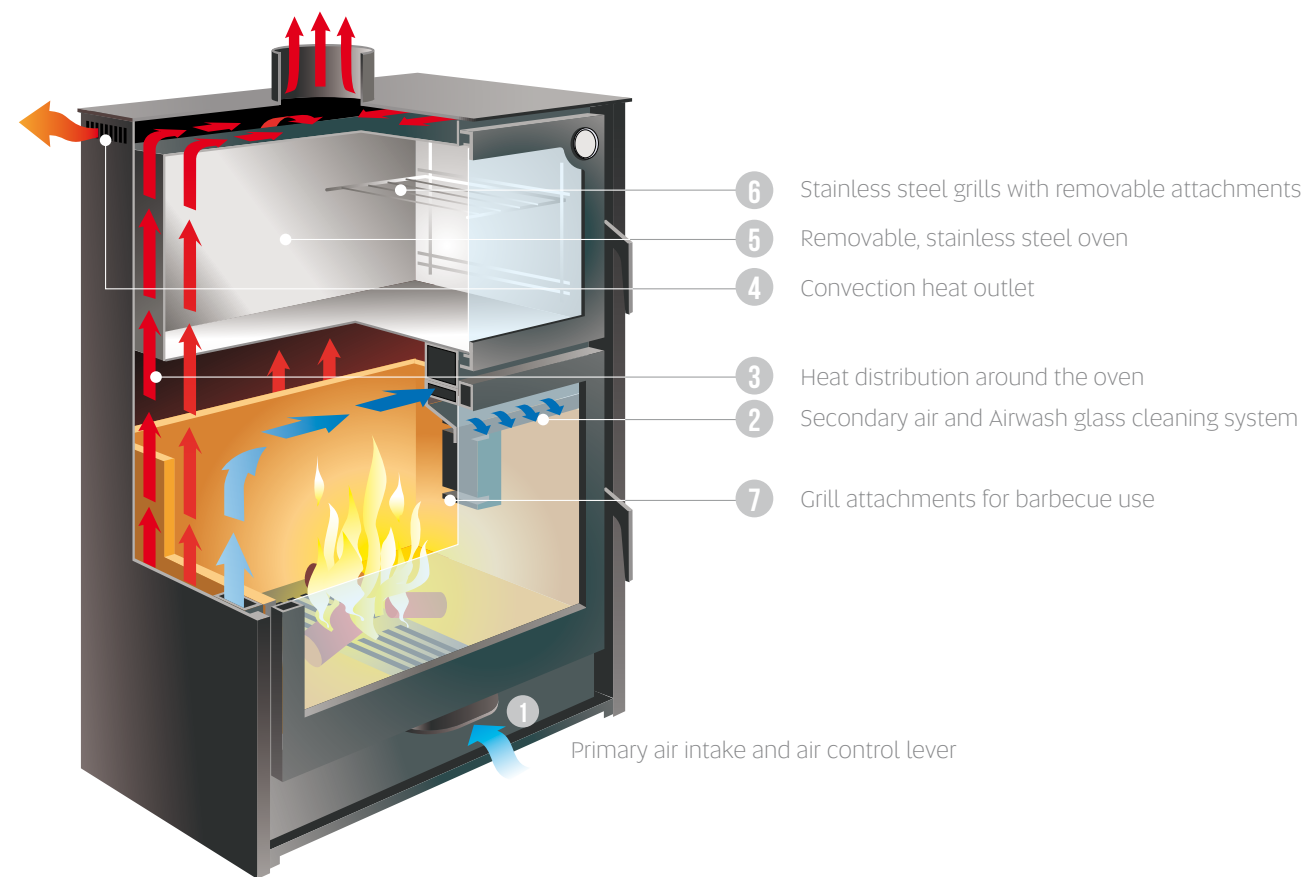

# ARCE

Nominal heat output: 12 kw  
 Efficiency: 80,1 %  
 Dimensions (An. x AL. x P.): 705 x 1.075 x 440



Aranda wood-fired oven is fully built in cast iron, with a stainless steel oven and oven light.

# ARANDA

Nominal heat output: 12,5 kw  
 Efficiency: 71 %  
 Dimensions (An. x AL. x P.): 700 x 975 x 725



# ARCE R

Nominal heat output: 12 kw  
 Efficiency: 80,1 %  
 Dimensions (An. x AL. x P.): 1.030 x 1.075 x 833







## CHOOSING THE RIGHT WOOD

Not all firewood is the same. Choosing the right wood is very important in order to enjoy a clean, efficient burn.

Avoid fresh wood: it will give less heat and it will generate creosote in the appliance and installation, requiring more cleaning and maintenance. Also avoid soft woods (pine and other conifers): they will burn too intensely, with high temperatures that can overfire the stove, eventually damaging inner components.

The best option is hard woods –maple, oak, beech- that burn slowly and keep long lasting embers.

Before wood is ready to be burnt, it requires to be seasoned for at least one year, reaching its optimum level of humidity (under 20%) after 2 years.

## GREEN HEAT

Wood is a natural, renewable and "CO<sub>2</sub> neutral" fuel. When you burn wood in a high efficiency Hergóm fireplace, the amount of CO<sub>2</sub> released into the atmosphere is higher than if it had followed its natural process of decomposition in the forest. The ratio of CO<sub>2</sub> produced in the combustion is so low that the trees themselves absorb it through photosynthesis, transforming carbon back into wood. Contrary to what happens with fossil fuels, this absorption-release cycle can be repeated indefinitely, without producing an excess of CO<sub>2</sub>. According to estimates by the Environmental Protection Agency of the United States, an increase in the amount of fuel from biomass would significantly reduce the impact of greenhouse gases on the planet.

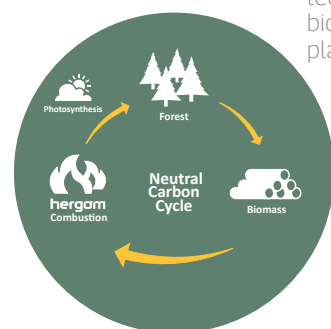

All Hergóm products are certified by the EC brand, which guarantees their performance in terms of efficiency and thermal values. Still, we work hard to overcome the strictest international controls, far exceeding the minimum requirements regarding performance, CO emissions and particles. By using wood as a fuel in a Hergóm hearth with maximum efficiency, you will be contributing to a cleaner and more sustainable world.





# TECHNICAL INFORMATION

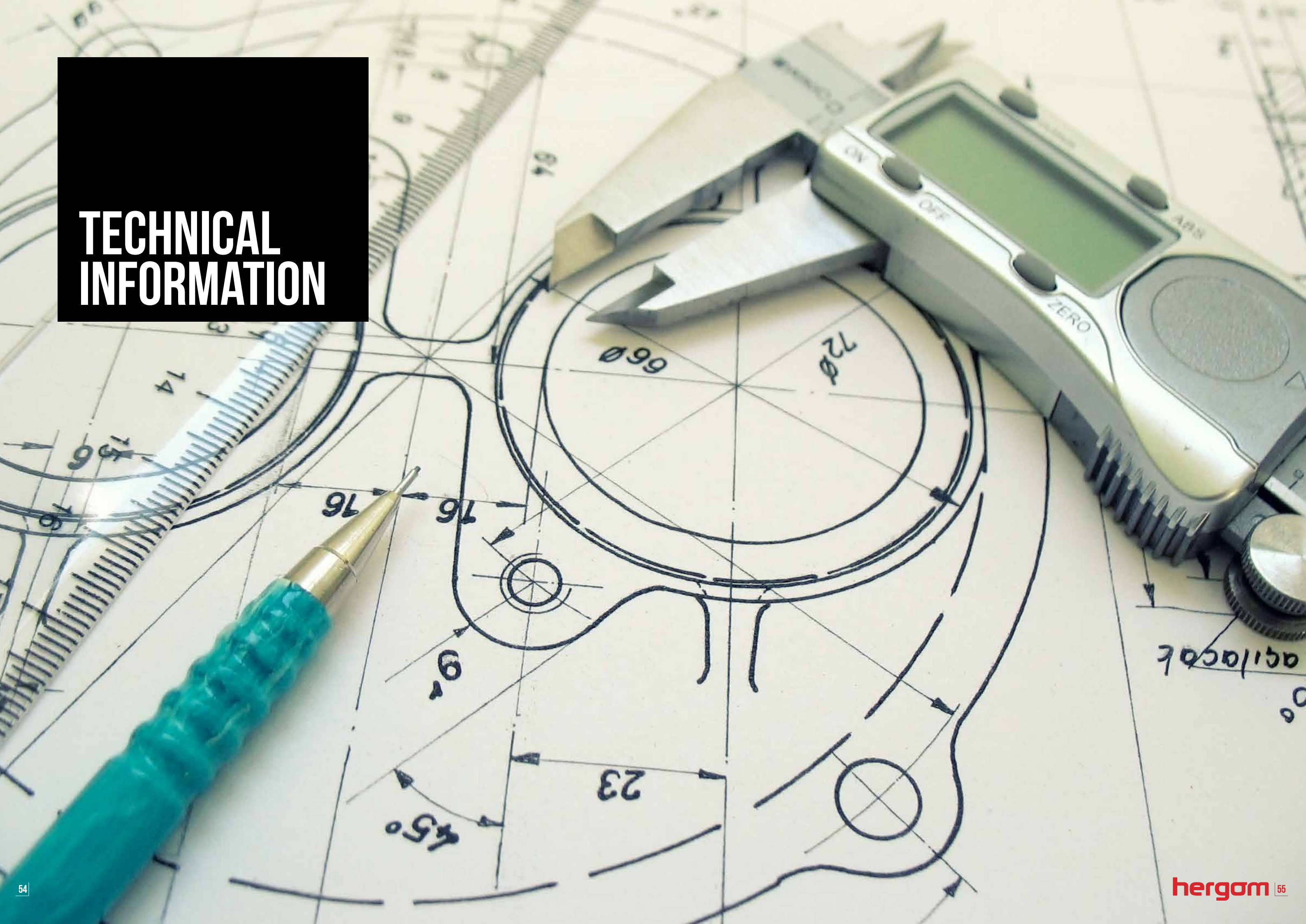



TECHNICAL INFORMATION

STOVES

GLANCE

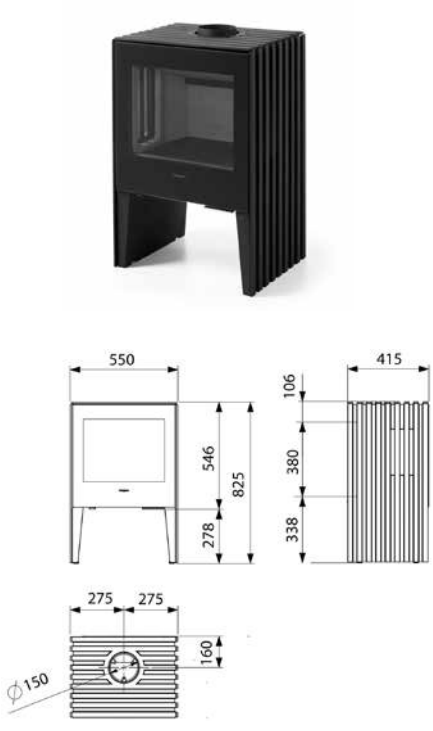

Nominal heat output (kW)	7
Efficiency (%)	80%
Maximum log length (mm)	400
Weight (kg)	160
Flue exit	Top & Rear
Flue exit diameter (mm)	150
Clearance to combustibles (Sides/Rear) (mm)	500/150
Fuel	Wood
Firebox material	Vermiculite
External air inlet	Yes
Ash pan	Yes
Paint finish	Black
Enamel finish	-

GLANCE PARED

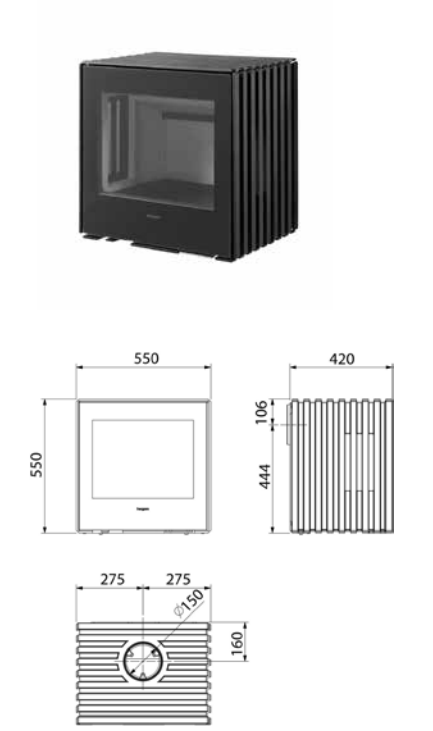

Nominal heat output (kW)	7
Efficiency (%)	80%
Maximum log length (mm)	400
Weight (kg)	150
Flue exit	Top & Rear
Flue exit diameter (mm)	-
Clearance to combustibles (Sides/Rear) (mm)	500/*
Fuel	Wood
Firebox material	Vermiculite
External air inlet	Yes
Ash pan	Yes
Paint finish	Black
Enamel finish	-

GLANCE L

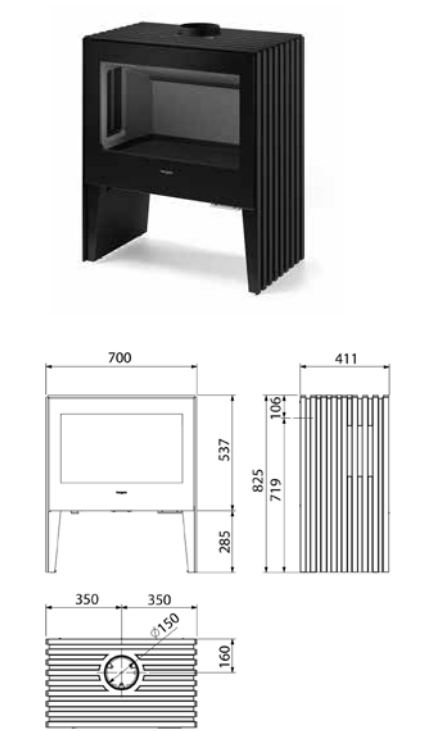

Nominal heat output (kW)	7
Efficiency (%)	80%
Maximum log length (mm)	400
Weight (kg)	160
Flue exit	Top & Rear
Flue exit diameter (mm)	-
Clearance to combustibles (Sides/Rear) (mm)	400/400
Fuel	Wood
Firebox material	Vermiculite
External air inlet	Yes
Ash pan	Yes
Paint finish	Black
Enamel finish	-

E-40

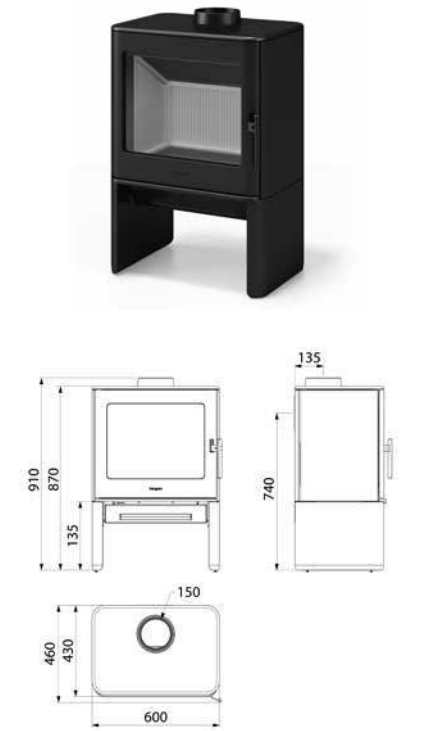

Nominal heat output (kW)	9
Efficiency (%)	79%
Maximum log length (mm)	500
Weight (kg)	150
Flue exit	Top & Rear
Flue exit diameter (mm)	-
Clearance to combustibles (Sides/Rear) (mm)	450/450
Fuel	Wood
Firebox material	Vermiculite
External air inlet	Yes
Ash pan	Yes
Paint finish	Black
Enamel finish	-



E-30 L

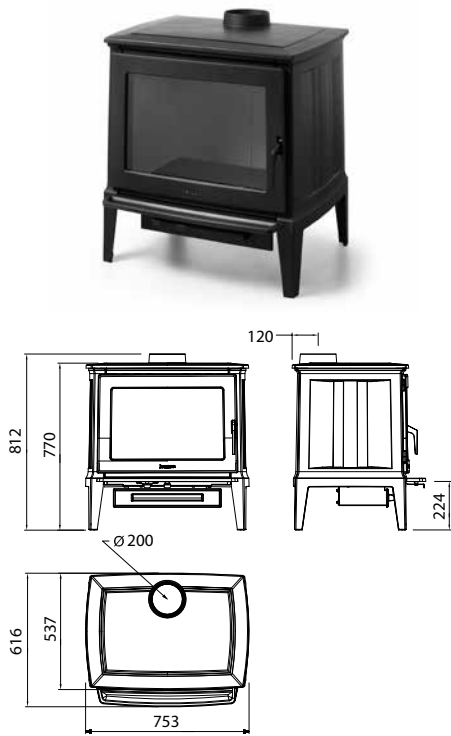

Nominal heat output (kW)	11
Efficiency (%)	79%
Maximum log length (mm)	600
Weight (kg)	190
Flue exit	Top
Flue exit diameter (mm)	200
Clearance to combustibles (Sides/Rear) (mm)	450/450

Fuel	Wood
Firebox material	Cast iron
External air inlet	Yes
Ash pan	Yes
Paint finish	Black
Enamel finish	-

E-30 M

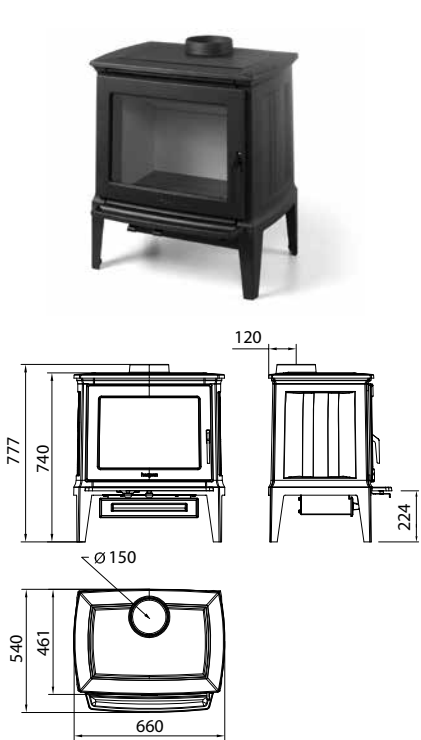

Nominal heat output (kW)	9
Efficiency (%)	79%
Maximum log length (mm)	500
Weight (kg)	150
Flue exit	Top & Rear
Flue exit diameter (mm)	150
Clearance to combustibles (Sides/Rear) (mm)	450/450

Fuel	Wood
Firebox material	Cast iron
External air inlet	Yes
Ash pan	Yes
Paint finish	Black
Enamel finish	-

E-30 S

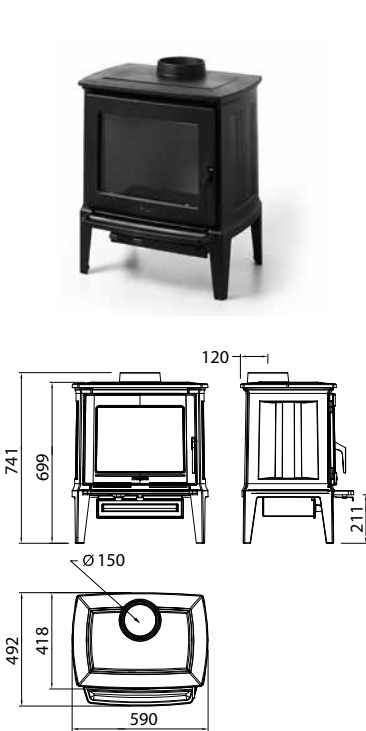

Nominal heat output (kW)	7
Efficiency (%)	79%
Maximum log length (mm)	400
Weight (kg)	110
Flue exit	Top
Flue exit diameter (mm)	150
Clearance to combustibles (Sides/Rear) (mm)	450/450

Fuel	Wood
Firebox material	Cast iron
External air inlet	Yes
Ash pan	Yes
Paint finish	Black
Enamel finish	-

E-30 XS

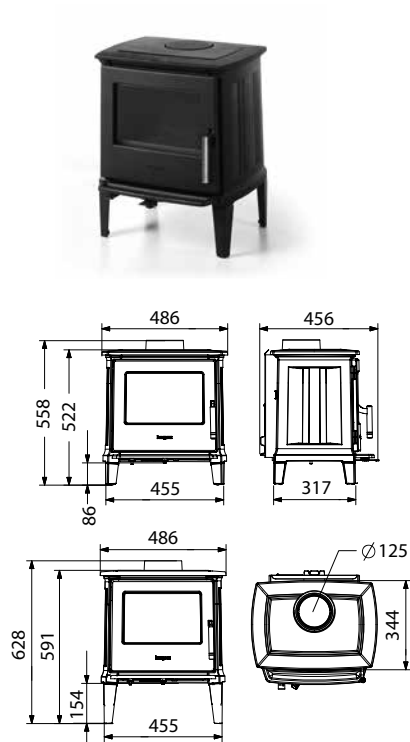

Nominal heat output (kW)	5
Efficiency (%)	77%* / 80%*
Maximum log length (mm)	350
Weight (kg)	1900
Flue exit	Top & Rear
Flue exit diameter (mm)	125
Clearance to combustibles (Sides/Rear) (mm)	450/250

Fuel	Wood / Coal
Firebox material	Cast iron
External air inlet	Yes
Ash pan	Yes
Paint finish	Black
Enamel finish	-

E-20 NS

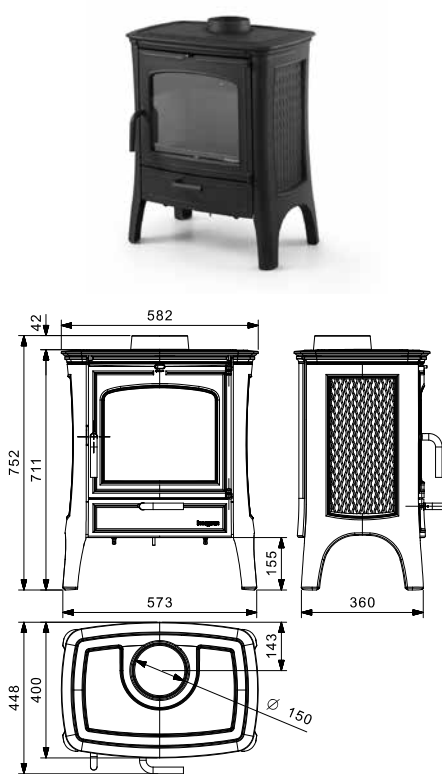

Nominal heat output (kW)	9
Efficiency (%)	75%
Maximum log length (mm)	420
Weight (kg)	105
Flue exit	Top
Flue exit diameter (mm)	150
Clearance to combustibles (Sides/Rear) (mm)	600/600

Fuel	Wood
Firebox material	Refractory
External air inlet	Yes
Ash pan	Yes
Paint finish	Black
Enamel finish	-

MANCHESTER

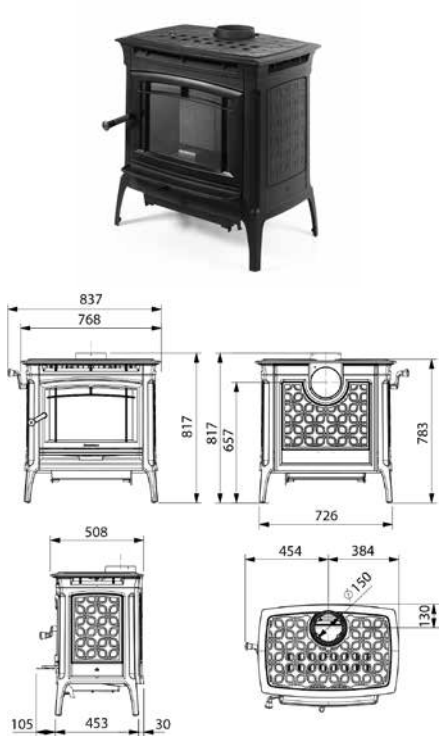

Nominal heat output (kW)	13
Efficiency (%)	75%
Maximum log length (mm)	600
Weight (kg)	236
Flue exit	Top & Rear
Flue exit diameter (mm)	150
Clearance to combustibles (Sides/Rear) (mm)	500/300

Fuel	Wood
Firebox material	Soapstone
External air inlet	Yes
Ash pan	Yes
Paint finish	Black
Enamel finish	Brown/Ivory



BENNINGTON



Nominal heat output (kW)	13
Efficiency (%)	75%
Maximum log length (mm)	570
Weight (kg)	210
Flue exit	Top & Rear
Flue exit diameter (mm)	150
Clearance to combustibles (Sides/Rear) (mm)	460/400
Fuel	Wood
Firebox material	Refractory
External air inlet	Yes
Ash pan	Yes
Paint finish	Black
Enamel finish	Brown/Ivory

SHELBURNE



Nominal heat output (kW)	10,5
Efficiency (%)	78,5%
Maximum log length (mm)	480
Weight (kg)	180
Flue exit	Top & Rear
Flue exit diameter (mm)	150
Clearance to combustibles (Sides/Rear) (mm)	460/610
Fuel	Wood
Firebox material	Refractory
External air inlet	Yes
Ash pan	Yes
Paint finish	Black
Enamel finish	Brown

CRAFTSBURY



Nominal heat output (kW)	11,5
Efficiency (%)	84%
Maximum log length (mm)	450
Weight (kg)	130
Flue exit	Top & Rear
Flue exit diameter (mm)	150
Clearance to combustibles (Sides/Rear) (mm)	460/610
Fuel	Wood
Firebox material	Soapstone
External air inlet	Yes
Ash pan	Yes
Paint finish	Black
Enamel finish	Brown/Ivory

HERITAGE

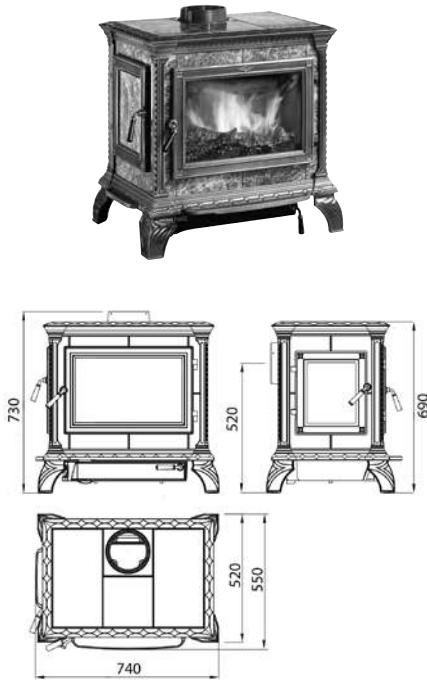

Nominal heat output (kW)	16,3
Efficiency (%)	79%
Maximum log length (mm)	540
Weight (kg)	216
Flue exit	Top & Rear
Flue exit diameter (mm)	150
Clearance to combustibles (Sides/Rear) (mm)	430/400
Fuel	Wood
Firebox material	Soapstone
External air inlet	Yes
Ash pan	Yes
Paint finish	Black
Enamel finish	Seafoam



TECHNICAL INFORMATION

FIREPLACE  
INSERTS

C-12

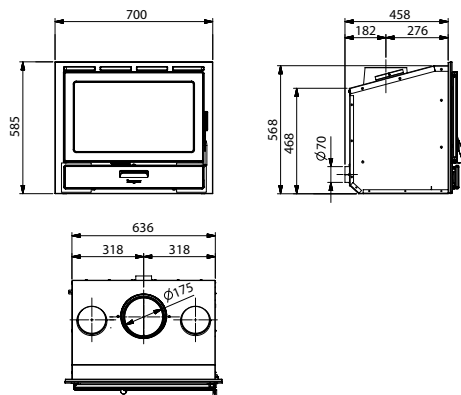

Nominal heat output (kW)	9
Efficiency (%)	75%
Maximum log length (mm)	500
Weight (kg)	120
Flue exit diameter (mm)	175
Air outlets diameter (mm)	120

Fuel	Wood
Firebox material	Cast iron
Convection jacket	Yes
Air outlets	2
Convection blower(s)	Yes
External air inlet	Yes
Ash pan	Yes
Paint finish	Black

SERE-100 2C

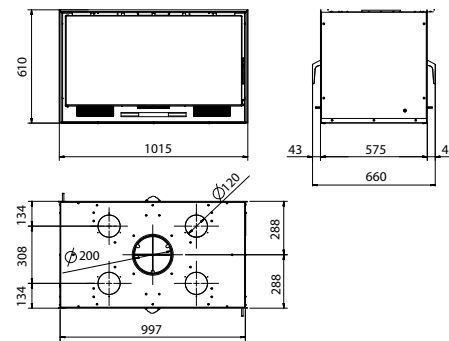

Nominal heat output (kW)	12
Efficiency (%)	78%
Maximum log length (mm)	700
Weight (kg)	138
Flue exit diameter (mm)	200
Air outlets diameter (mm)	120

Fuel	Wood
Firebox material	Vermiculite
Convection jacket	Yes
Air outlets	4
Convection blower(s)	Opcional
External air inlet	No
Ash pan	Yes
Paint finish	Black

SERE-100

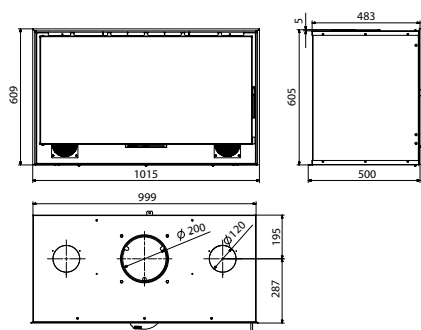

Nominal heat output (kW)	12
Efficiency (%)	75%
Maximum log length (mm)	700
Weight (kg)	134
Flue exit diameter (mm)	200
Air outlets diameter (mm)	120

Fuel	Wood
Firebox material	Cast iron or Vermiculite
Convection jacket	Yes
Air outlets	2
Convection blower(s)	Opcional
External air inlet	Yes
Ash pan	Yes
Paint finish	Black

SERE-80

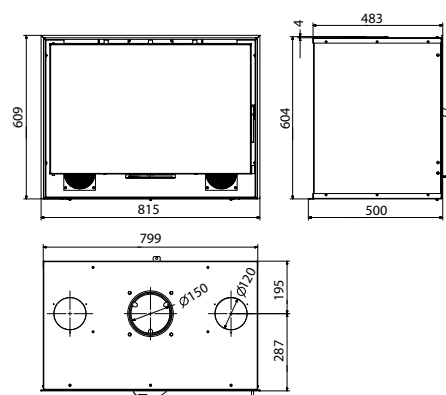

Nominal heat output (kW)	10
Efficiency (%)	73%
Maximum log length (mm)	550
Weight (kg)	114
Flue exit diameter (mm)	150
Air outlets diameter (mm)	120

Fuel	Wood
Firebox material	Cast iron or Vermiculite
Convection jacket	Yes
Air outlets	2
Convection blower(s)	Opcional
External air inlet	Yes
Ash pan	Yes
Paint finish	Black



SERE-70

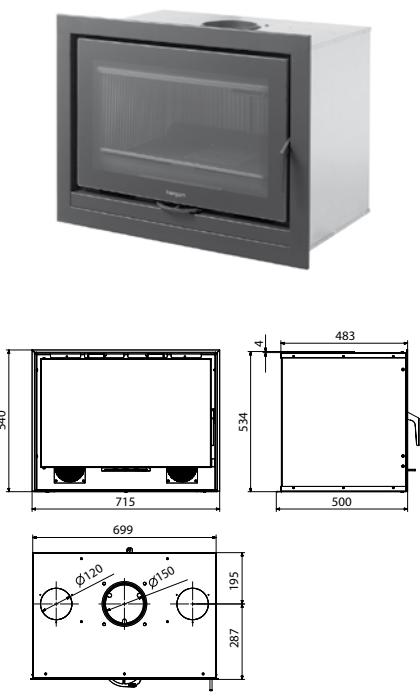

Nominal heat output (kW)	9
Efficiency (%)	71%
Maximum log length (mm)	500
Weight (kg)	114
Flue exit diameter (mm)	150
Air outlets diameter (mm)	120

Fuel	Wood
Firebox material	Cast iron or Vermiculite
Convection jacket	Yes
Air outlets	2
Convection blower(s)	Yes
External air inlet	Yes
Ash pan	Yes
Paint finish	Black

NATURE 100

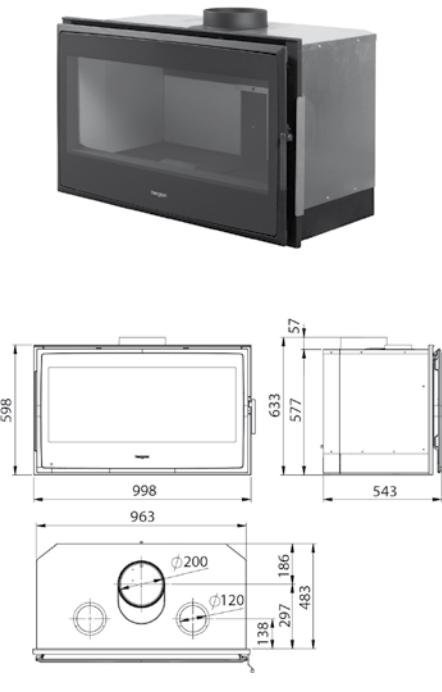

Nominal heat output (kW)	12
Efficiency (%)	77%
Maximum log length (mm)	700
Weight (kg)	134
Flue exit diameter (mm)	200
Air outlets diameter (mm)	120

Fuel	Wood
Firebox material	Cast iron or Vermiculite
Convection jacket	Yes
Air outlets	2
Convection blower(s)	Yes
External air inlet	Yes
Ash pan	Yes
Paint finish	Black

NATURE 80

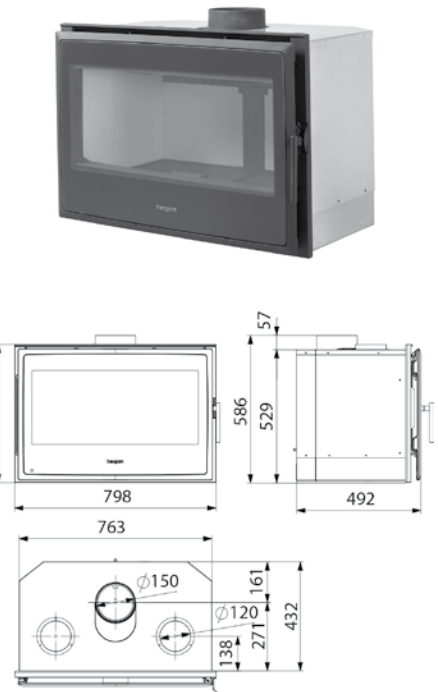

Nominal heat output (kW)	10
Efficiency (%)	76%
Maximum log length (mm)	550
Weight (kg)	114
Flue exit diameter (mm)	150
Air outlets diameter (mm)	120

Fuel	Wood
Firebox material	Cast iron or Vermiculite
Convection jacket	Yes
Air outlets	2
Convection blower(s)	Yes
External air inlet	Yes
Ash pan	Yes
Paint finish	Black

NATURE 70

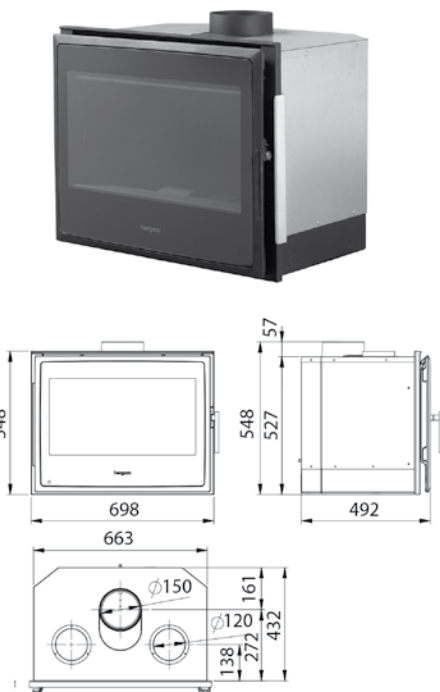

Nominal heat output (kW)	8,5
Efficiency (%)	75%
Maximum log length (mm)	500
Weight (kg)	95
Flue exit diameter (mm)	150
Air outlets diameter (mm)	120

Fuel	Wood
Firebox material	Cast iron or Vermiculite
Convection jacket	Yes
Air outlets	2
Convection blower(s)	Yes
External air inlet	Yes
Ash pan	Yes
Paint finish	Black

STILKAMIN XL

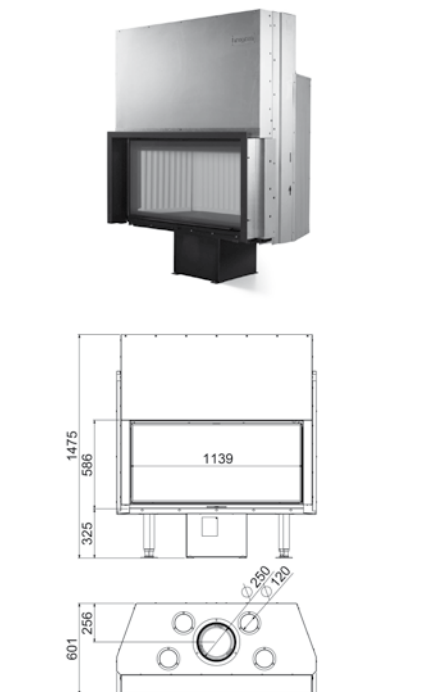

Nominal heat output (kW)	23
Efficiency (%)	75%
Maximum log length (mm)	750
Weight (kg)	308
Flue exit diameter (mm)	250
Air outlets diameter (mm)	120

Fuel	Wood
Firebox material	Refractory
Convection jacket	Yes
Air outlets	4
Convection blower(s)	Optional
External air inlet	No
Ash pan	Yes
Paint finish	Black

STILKAMIN L

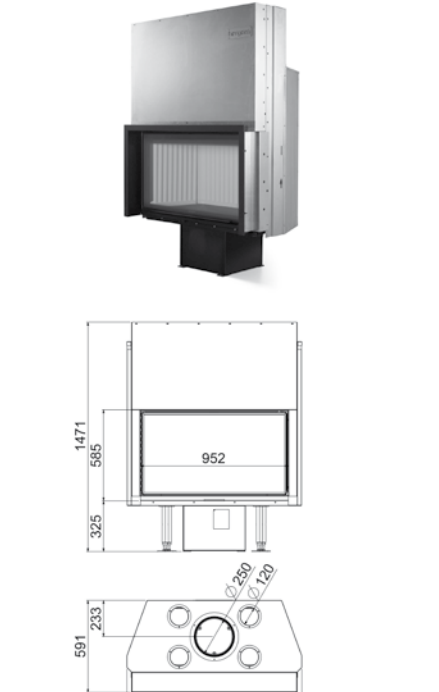

Nominal heat output (kW)	20
Efficiency (%)	76%
Maximum log length (mm)	550
Weight (kg)	268
Flue exit diameter (mm)	250
Air outlets diameter (mm)	120

Fuel	Wood
Firebox material	Refractory
Convection jacket	Yes
Air outlets	4
Convection blower(s)	Optional
External air inlet	No
Ash pan	Yes
Paint finish	Black



STILKAMIN S 460

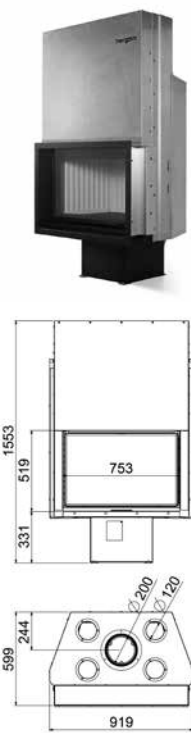

Nominal heat output (kW)	17
Efficiency (%)	79%
Maximum log length (mm)	600
Weight (kg)	250
Flue exit diameter (mm)	200
Air outlets diameter (mm)	120

Fuel	Wood
Firebox material	Refractory
Convection jacket	Yes
Air outlets	4
Convection blower(s)	Optional
External air inlet	No
Ash pan	Yes
Paint finish	Black

STILKAMIN S 600

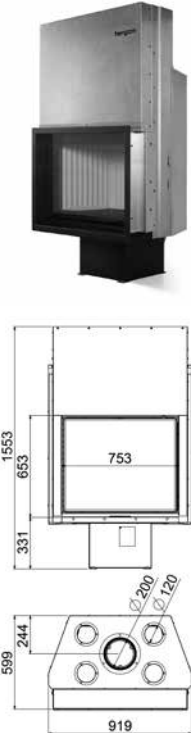

Nominal heat output (kW)	17
Efficiency (%)	77%
Maximum log length (mm)	600
Weight (kg)	258
Flue exit diameter (mm)	200
Air outlets diameter (mm)	120

Fuel	Wood
Firebox material	Refractory
Convection jacket	Yes
Air outlets	4
Convection blower(s)	Optional
External air inlet	No
Ash pan	Yes
Paint finish	Black

ECK

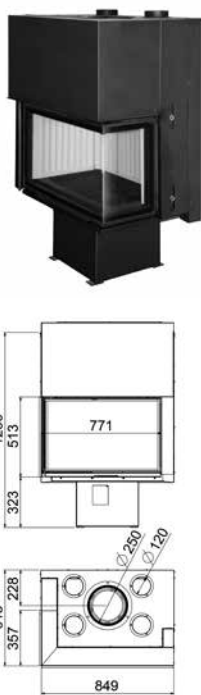

Nominal heat output (kW)	13
Efficiency (%)	75%
Maximum log length (mm)	600
Weight (kg)	256
Flue exit diameter (mm)	250
Air outlets diameter (mm)	120

Fuel	Wood
Firebox material	Refractory
Convection jacket	Yes
Air outlets	4
Convection blower(s)	Optional
External air inlet	No
Ash pan	Yes
Paint finish	Black

HGB 70

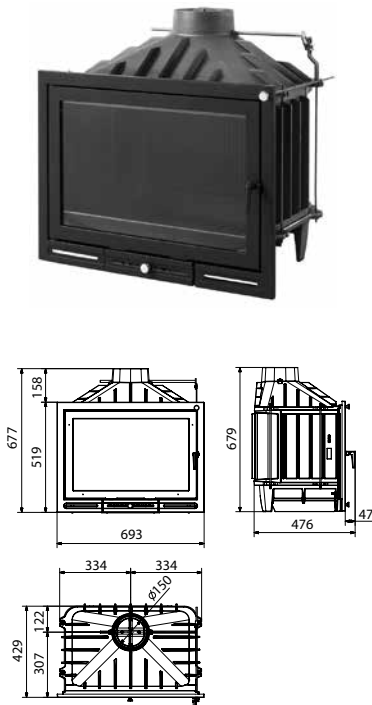

Nominal heat output (kW)	11
Efficiency (%)	80%
Maximum log length (mm)	6500
Weight (kg)	117
Flue exit diameter (mm)	150
Air outlets diameter (mm)	-

Fuel	Wood
Firebox material	Cast iron
Convection jacket	No
Air outlets	No
Convection blower(s)	No
External air inlet	Yes
Ash pan	Yes
Paint finish	Black

H 03/70 PLANE

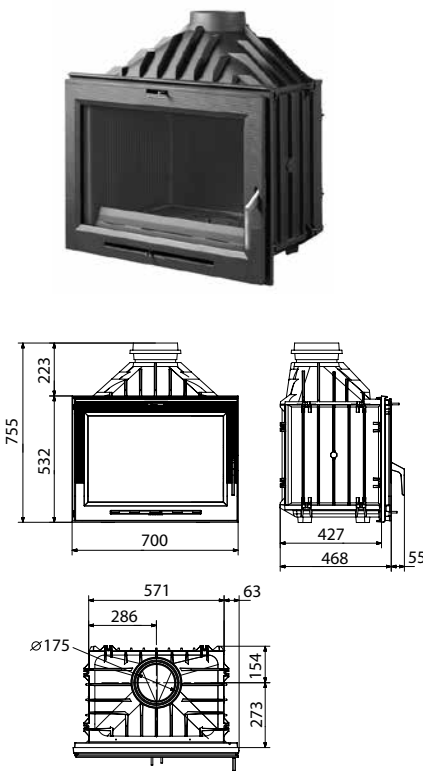

Nominal heat output (kW)	10
Efficiency (%)	76,5%
Maximum log length (mm)	500
Weight (kg)	135
Flue exit diameter (mm)	175
Air outlets diameter (mm)	-

Fuel	Wood
Firebox material	Cast iron
Convection jacket	No
Air outlets	No
Convection blower(s)	No
External air inlet	No
Ash pan	Yes
Paint finish	Black

H 03/80 PLANE

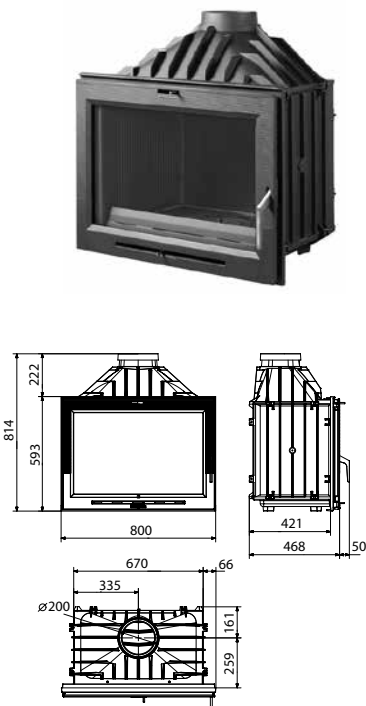

Nominal heat output (kW)	13
Efficiency (%)	76%
Maximum log length (mm)	550
Weight (kg)	147
Flue exit diameter (mm)	200
Air outlets diameter (mm)	-

Fuel	Wood
Firebox material	Cast iron
Convection jacket	No
Air outlets	No
Convection blower(s)	No
External air inlet	No
Ash pan	Yes
Paint finish	Black



H 03/70 TURBO PLANE

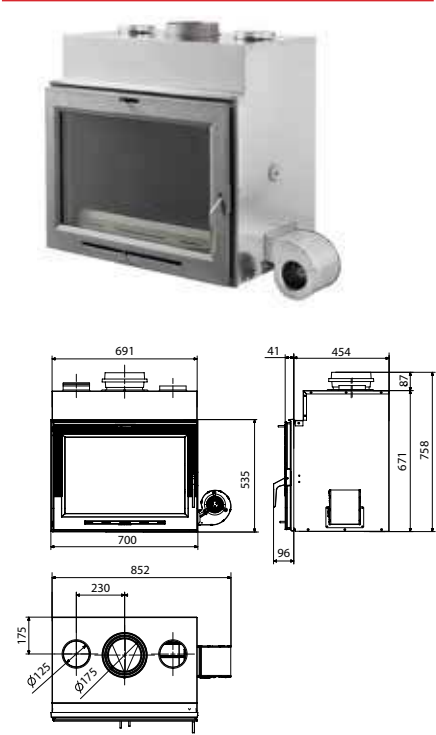

Nominal heat output (kW)	10
Efficiency (%)	76,5%
Maximum log length (mm)	500
Weight (kg)	135
Flue exit diameter (mm)	175
Air outlets diameter (mm)	125
Fuel	Wood
Firebox material	Cast iron
Convection jacket	Yes
Air outlets	2
Convection blower(s)	Yes
External air inlet	No
Ash pan	Yes
Paint finish	Black

H 03/80 TURBO PLANE

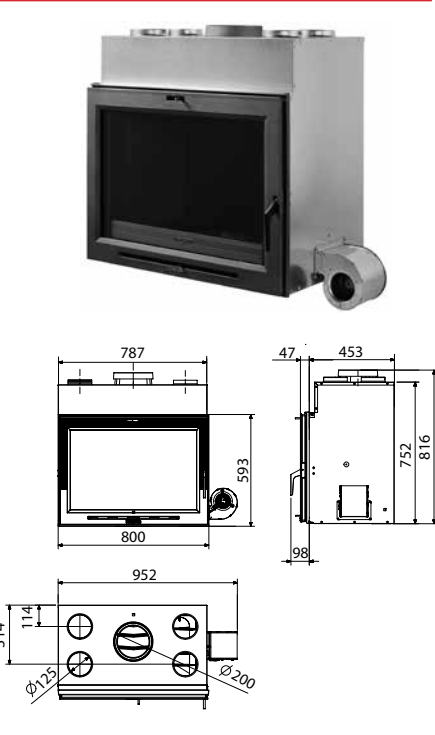

Nominal heat output (kW)	13
Efficiency (%)	76%
Maximum log length (mm)	550
Weight (kg)	147
Flue exit diameter (mm)	200
Air outlets diameter (mm)	125
Fuel	Wood
Firebox material	Cast iron
Convection jacket	Yes
Air outlets	2
Convection blower(s)	Yes
External air inlet	No
Ash pan	Yes
Paint finish	Black

H 03/80 BOILER

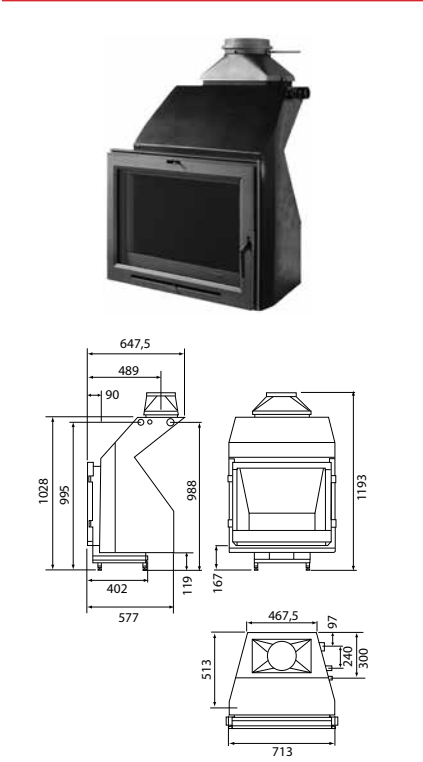

Nominal heat output (kW)	25
Nominal heat output to water (kW)	18
Nominal heat output to air (kW)	15
Efficiency (%)	70%
Maximum log length (mm)	500
Maximum water temperature (°C)	80
Maximum pressure (bar)	2
Weight (kg)	223
Flue exit diameter (mm)	200
Fuel	Wood
Firebox material	Steel
Draft valve	Yes
Cooling coil	No
External air inlet	No
Ash pan	Yes
Paint finish	Grey

H 03/70 BOILER

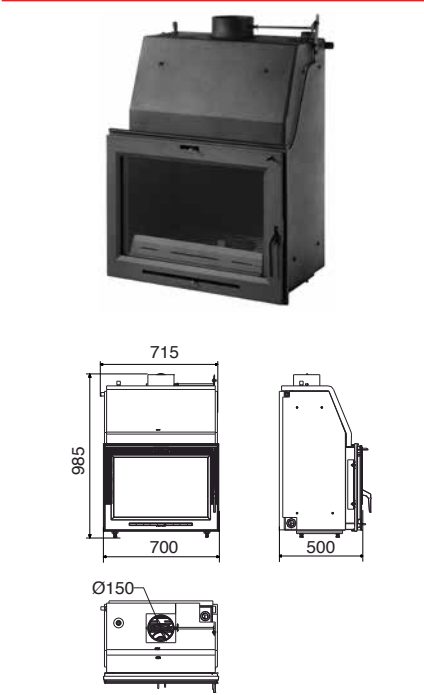

Nominal heat output (kW)	22
Nominal heat output to water (kW)	12
Nominal heat output to air (kW)	10
Efficiency (%)	83%
Maximum log length (mm)	500
Maximum water temperature (°C)	80
Maximum pressure (bar)	2
Weight (kg)	163
Flue exit diameter (mm)	150
Fuel	Wood
Firebox material	Steel
Draft valve	Yes
Cooling coil	Yes
External air inlet	No
Ash pan	Yes
Paint finish	Grey

DERO BOILER

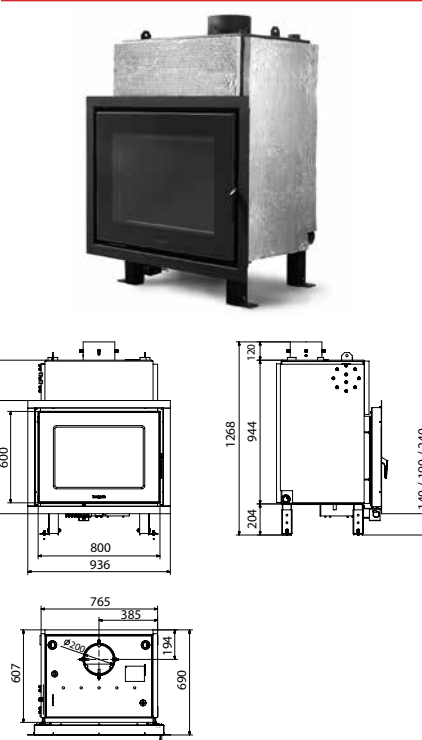

Nominal heat output (kW)	35
Nominal heat output to water (kW)	21
Nominal heat output to air (kW)	14
Efficiency (%)	73%
Maximum log length (mm)	500
Maximum water temperature (°C)	80
Maximum pressure (bar)	2
Weight (kg)	271
Flue exit diameter (mm)	200
Fuel	Wood
Firebox material	Steel
Draft valve	Yes
Cooling coil	Optional
External air inlet	No
Ash pan	Yes
Paint finish	Black

H 02/22 BOILER

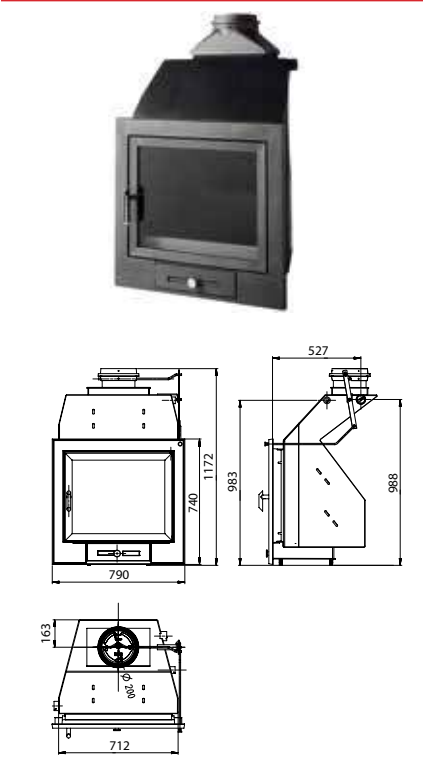

Nominal heat output (kW)	25
Nominal heat output to water (kW)	18
Nominal heat output to air (kW)	15
Efficiency (%)	70%
Maximum log length (mm)	500
Maximum water temperature (°C)	80
Maximum pressure (bar)	2
Weight (kg)	223
Flue exit diameter (mm)	200
Fuel	Wood
Firebox material	Steel
Draft valve	Yes
Cooling coil	No
External air inlet	No
Ash pan	Yes
Paint finish	Black



TECHNICAL INFORMATION

WOOD FIRED OVENS

ARANDA

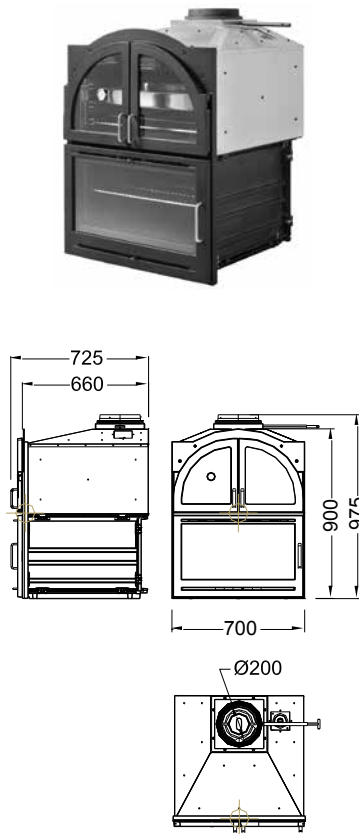

Nominal heat output (kW)	12,5
Efficiency (%)	71%
Oven dimensions (W x H x D) (mm)	570 x 300 x 620
Maximum log length (mm)	500
Weight (kg)	242
Flue exit	Top
Flue exit diameter (mm)	200
Clearance to combustibles (Sides/Rear) (mm)	*
Fuel	Wood
Firebox material	Cast iron
Oven material	Stainless steel
Removable grills	Yes
Draft valve	Yes
External air inlet	No
Ash pan	Yes
Paint finish	Black

ARCE

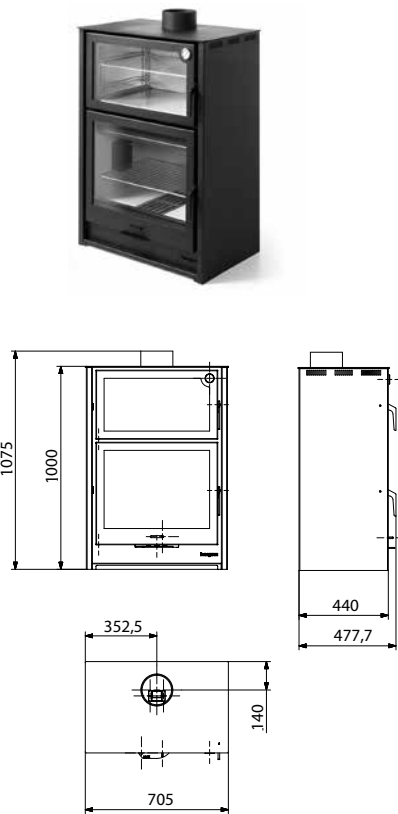

Nominal heat output (kW)	12
Efficiency (%)	80%
Oven dimensions (W x H x D) (mm)	520 x 275 x 363
Maximum log length (mm)	150
Weight (kg)	242
Flue exit	Top
Flue exit diameter (mm)	150
Clearance to combustibles (Sides/Rear) (mm)	600/600
Fuel	Wood
Firebox material	Vermiculite
Oven material	Stainless steel
Removable grills	Yes
Draft valve	No
External air inlet	No
Ash pan	Yes
Paint finish	Black

ARCE R

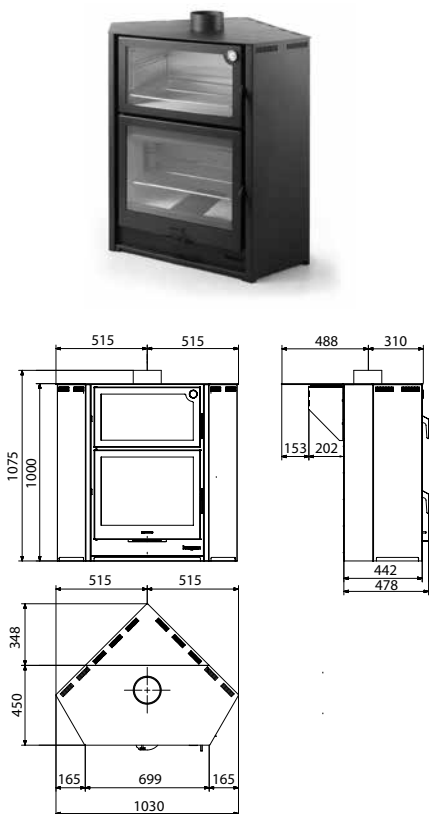

Nominal heat output (kW)	12
Efficiency (%)	80%
Oven dimensions (W x H x D) (mm)	520 x 275 x 363
Maximum log length (mm)	500
Weight (kg)	150
Flue exit	Top
Flue exit diameter (mm)	150
Clearance to combustibles (Sides/Rear) (mm)	*
Fuel	Wood
Firebox material	Vermiculite
Oven material	Stainless steel
Removable grills	Yes
Draft valve	No
External air inlet	No
Ash pan	Yes
Paint finish	Black





**Industrias Hergóm, S.A.**

39110 SOTO DE LA MARINA (Cantabria)

Apartado de Correos 208 de Santander

39080 Santander (España)

Tel.: +34 942 58 70 00 / Fax: +34 942 58 70 01

comercial@hergom.com

**hergom.com**